



2" Aluminum Brick Mould for Aluminum/Wood Arch & Springline Products

FORMULAS:

BRICK MOULD **HEIGHT** =
BASIC UNIT HEIGHT + 2.062"

BRICK MOULD **WIDTH** =
BASIC UNIT WIDTH + 2.625"

Part Numbers

COLOR	LINEAL	14' 6"	20'
WHITE	017316	017280	017287
BRONZE	017317	017285	017292
SAND	017318	017282	017289
GREEN	017319	017283	017290
RED	017320	017281	017288
EGGSHELL	017321	017284	017291
JET BLACK	017322	017286	017293

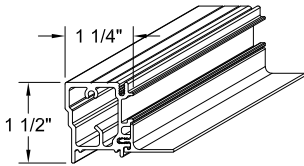

Fastener Adder
L/F PART# 977245

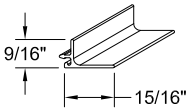

Corner Gasket
2 Required Per Unit
Apply One at each corner
at the head.

PART#		
WHITE	BLACK	SAND
092625	092626	092627

3/4" x 1 1/2" Simulated Aluminum Sill Nosing

COLOR	PART#	Lineal Foot Part#'s
WHITE	012984	
BRONZE	012985	
SAND	012986	
GREEN	012987	
RED	012989	
EGGSHELL	012990	
JET BLACK	095633	

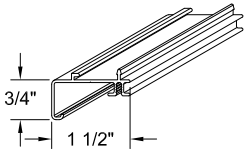

Pan Head Fastening screws
#6 x 5/8" for Head & Jamb
For fastening *Fastener Adder*

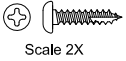

COLOR	PART#
WHITE	011635
BRONZE	011636
SAND	015517
GREEN	032142
RED	075321
EGGSHELL	075262

Flat Head ZINC screws
#6 x 3/4" PH FH for Sill

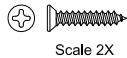

PART#	COLOR
010608	ZINC
014799	WHITE
015583	SAND
032141	GREEN

Scale: Drawn 1" = 1"

HEAD DETAIL
HURD ENERGY SAVER CLAD CASEMENT OPERATING

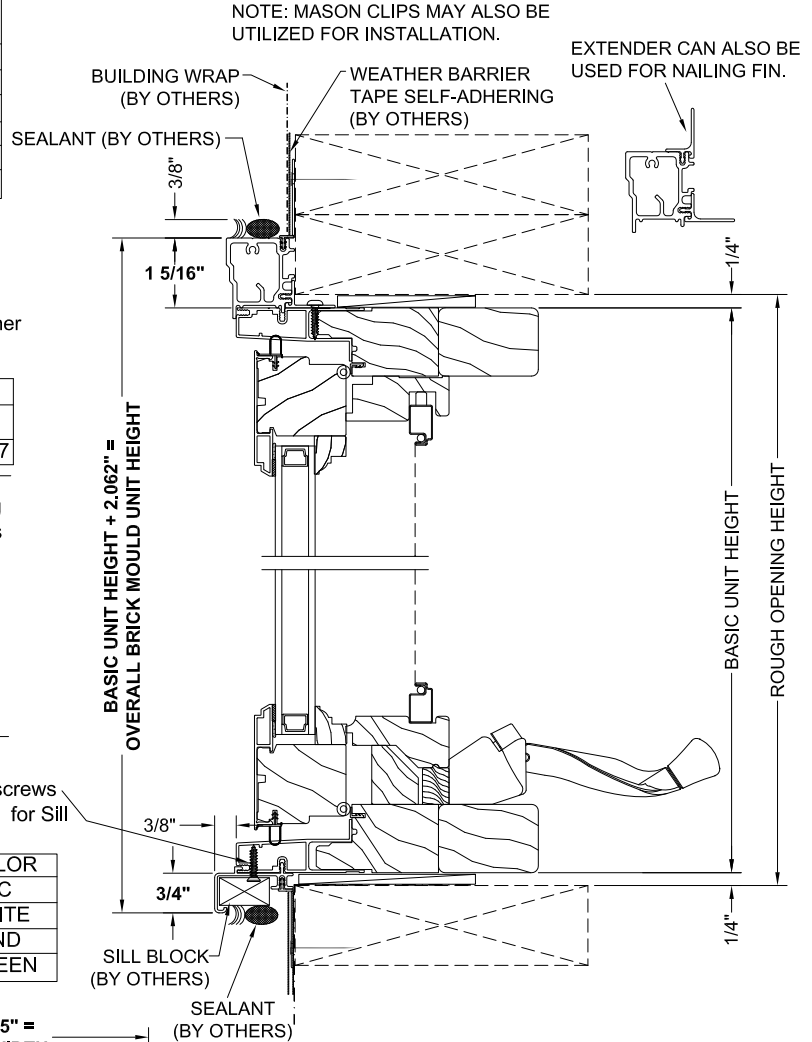

SILL DETAIL
HURD ENERGY SAVER CLAD CASEMENT OPERATING

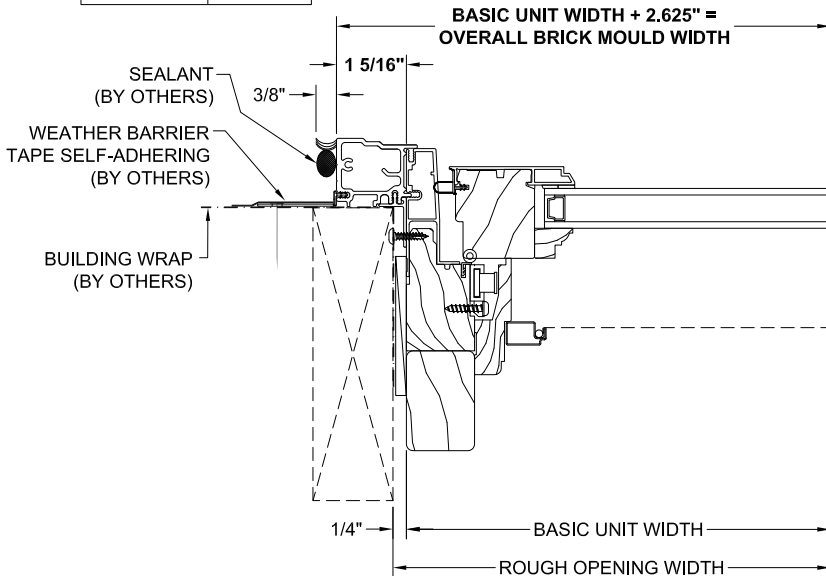

HWD Acquisition, Inc., offers these general suggestions for typical installations in the type of construction represented. This is a supplement and not a replacement to the full Installation Instructions provided by Hurd. You must use the full Installation Instructions in conjunction with this installation suggestion supplement. Full installation instruction can be found on the Hurd website, www.hurd.com. Installation requirements may vary in particular locations and in other types of construction. Proper installation is essential, and HWD Acquisitions, Inc., recommends consultation with an AAMA Certified Installer, or other qualified experienced building professional before installation of any Hurd product. Proper installation of Hurd products is the responsibility of the Installer. Hurd is not responsible for proper installation. Hurd is not responsible for the design of, conditions in, or performance of building construction beyond the perimeters of the Hurd units. Hurd is not responsible for proper integration of the Hurd units with the weather-repellent systems of the building.

JAMB DETAIL
HURD ENERGY SAVER CLAD CASEMENT OPERATING (TYP.)

FORMULAS:

BRICK MOULD **HEIGHT** =
BASIC UNIT HEIGHT + 1.3125"

BRICK MOULD **WIDTH** =
BASIC UNIT WIDTH + 2.625"

FASTENER ADDER CAN ALSO
BE USED FOR NAILING FIN.



HEAD DETAIL

HURD ENERGY SAVER CLAD INSWING ARCH PATIO DOOR

Scale: Drawn 1"=1"

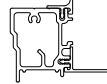

BUILDING WRAP (BY OTHERS)
WEATHER BARRIER TAPE SELF-ADHERING (BY OTHERS)

SEALANT (BY OTHERS)

*Applies to 1, 2 & 3
Panel Arch Inswing Doors*

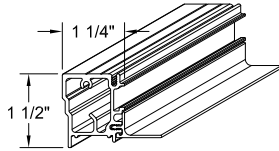

Part Numbers

COLOR	LINEAL	14' 6"	20'
WHITE	017316	017280	017287
BRONZE	017317	017285	017292
SAND	017318	017282	017289
GREEN	017319	017283	017290
RED	017320	017281	017288
EGGSHELL	017321	017284	017291
JET BLACK	017322	017286	017293

Fastener Adder
L/F PART# 977245

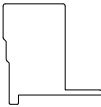
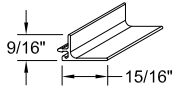

45° Corner Gasket
2 Required Per Unit
Apply One at each
corner at the head.

PART#		
WHITE	BLACK	SAND
092625	092626	092627

Pan Head Fastening screws
#6 x 5/8" for Head & Jamb

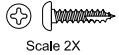

COLOR	PART#
WHITE	011635
BRONZE	011636
SAND	015517
GREEN	032142
RED	075321
EGGSHELL	075262

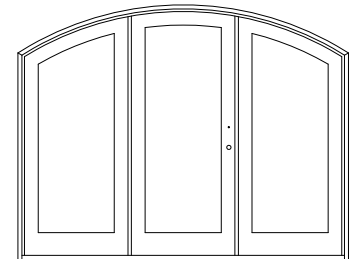
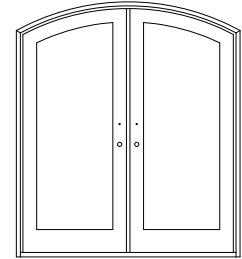
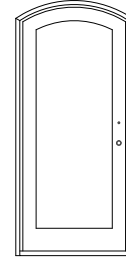
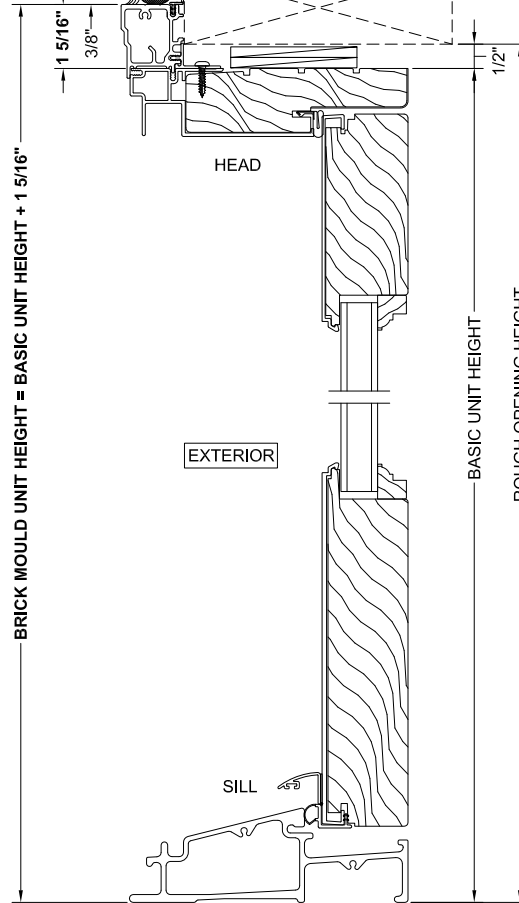

SILL DETAIL

HURD ENERGY SAVER CLAD INSWING ARCH PATIO DOOR

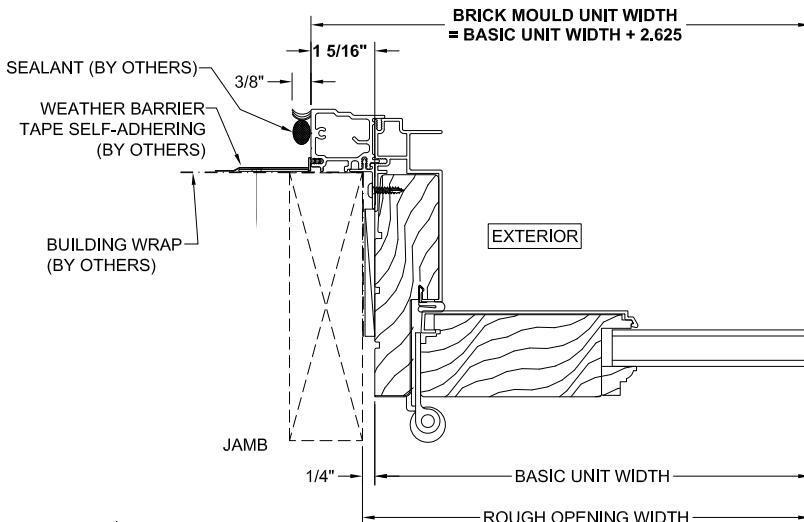

JAMB DETAIL

HURD ENERGY SAVER CLAD INSWING ARCH PATIO DOOR (TYP.)

HWD Acquisitions, Inc., offers these general suggestions for typical installations in the type of construction represented. This is a supplement and not a replacement to the full installation instructions provided by Hurd. You must use the full installation instructions in conjunction with this installation suggestion supplement. Full installation instruction can be found on the Hurd website, www.hurd.com. Installation requirements may vary in particular locations and in other types of construction. Proper installation is essential, and HWD Acquisitions, Inc., recommends consultation with an AAMA Certified Installer, or other qualified experienced building professional before installation of any Hurd product. Proper installation of Hurd products is the responsibility of the installer. Hurd is not responsible for proper installation. Hurd is not responsible for the design of, conditions in, or performance of building construction beyond the perimeters of the Hurd units. Hurd is not responsible for proper integration of the Hurd units with the weather-repellent systems of the building.



2 1/2" Ovalo Aluminum Brick Mould for Aluminum/Wood Arch & Springline Products

2009

FORMULAS:
BRICK MOULD **HEIGHT** =
BASIC UNIT HEIGHT + 2.50"

FORMULAS:
BRICK MOULD **WIDTH** =
BASIC UNIT WIDTH + 3.50"

Scale: Drawn 1" = 1"

Simulated 2 1/2" Ovalo Aluminum Brick Mould
144" Length Part Numbers

COLOR	PART#
WHITE	096718
BRONZE	096719
SAND	096720
GREEN	096721
RED	096723
EGGSHELL	096722
JET BLACK	096724

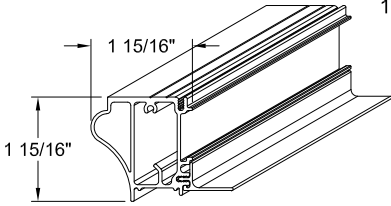

Fastener Adder
L/F PART# 977245

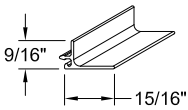

45° Corner Gasket
2 Required Per Unit
Apply One at each corner at the head.

PART#		
WHITE	BLACK	SAND
096290	096291	096292

3/4" x 2 1/8" Simulated Aluminum Sill Nosing
Lineal Foot Part#s

COLOR	PART#
WHITE	096726
BRONZE	096727
SAND	096728
GREEN	096729
RED	096731
EGGSHELL	096730
JET BLACK	096732

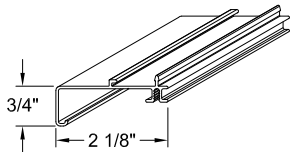

Pan Head Fastening screws
#6 x 5/8" for Head & Jamb

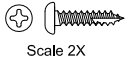

COLOR	PART#
WHITE	011635
BRONZE	011636
SAND	015517
GREEN	032142
RED	075321
EGGSHELL	075262

Flat Head ZINC screws
#6 x 3/4" PH FH for Sill

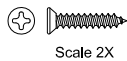

PART#	COLOR
010608	ZINC
014799	WHITE
015583	SAND
032141	GREEN

HEAD DETAIL HURD ENERGY SAVER CLAD CASEMENT OPERATING

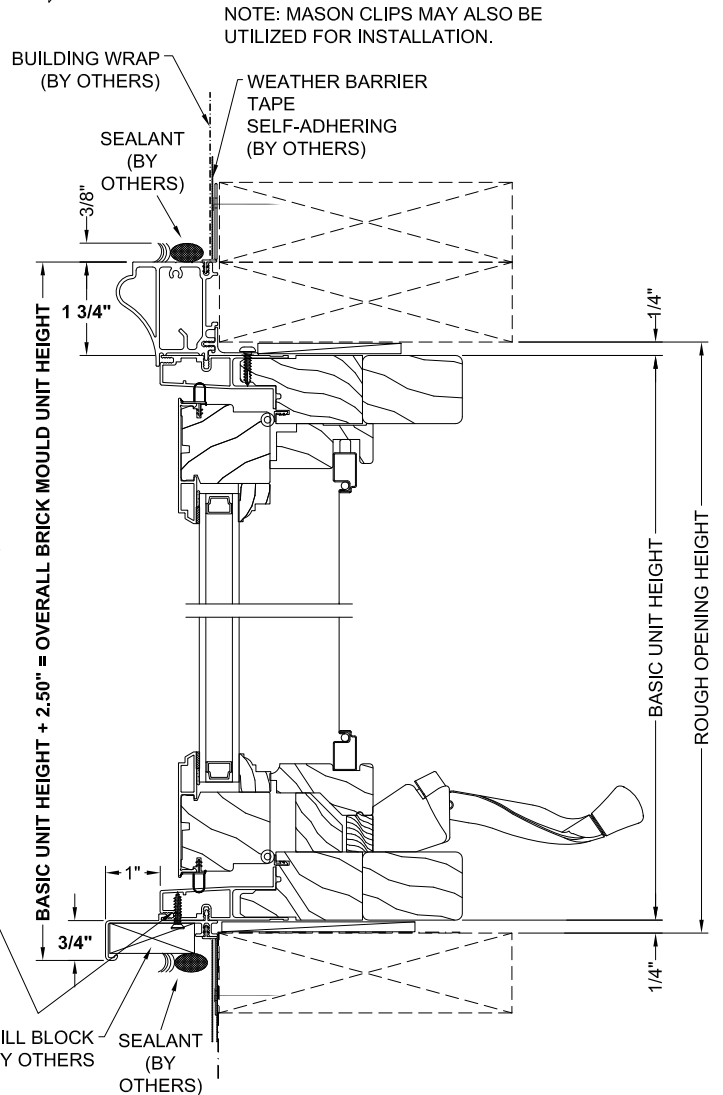

NOTE: MASON CLIPS MAY ALSO BE UTILIZED FOR INSTALLATION.

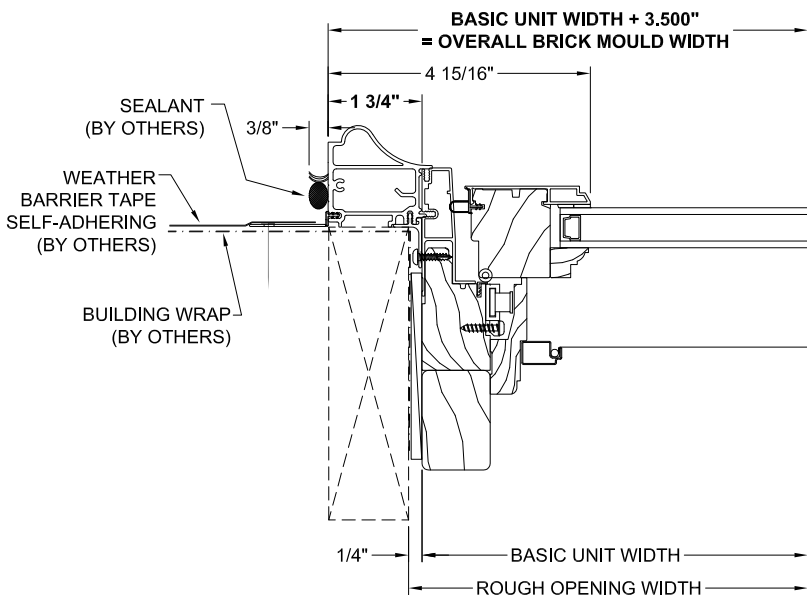

SILL DETAIL HURD ENERGY SAVER CLAD CASEMENT OPERATING

Hurd Acquisitions, Inc., offers these general suggestions for typical installations in the type of construction represented. This is a supplement and not a replacement to the full installation instructions provided by Hurd. You must use the full installation instructions in conjunction with this installation suggestion supplement. Full installation instruction can be found on the Hurd website, www.hurd.com. Installation requirements may vary in particular locations and in other types of construction. Proper installation is essential, and Hurd Acquisitions, Inc., recommends consultation with an AAMA Certified Installer, or other qualified experienced building professional before installation of any Hurd product. Proper installation of Hurd products is the responsibility of the installer. Hurd is not responsible for proper installation. Hurd is not responsible for the design of, conditions in, or performance of building construction beyond the perimeters of the Hurd units. Hurd is not responsible for proper integration of the Hurd units with the weather-repellent systems of the building.

JAMB DETAIL HURD ENERGY SAVER CLAD CASEMENT OPERATING (TYP.)

FORMULAS:

BRICK MOULD HEIGHT =
BASIC UNIT HEIGHT + 3.6875"

BRICK MOULD WIDTH =
BASIC UNIT WIDTH + 5.875"

Scale: Drawn 1" = 1"

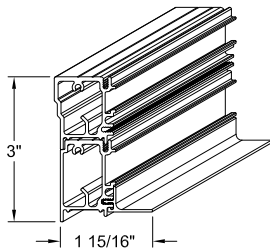

3 1/2" Aluminum Brick Mould L/F Part#

COLOR	PART#
WHITE	096609
BRONZE	096610
AND	096611
GREEN	096612
RED	096614
EGGSHELL	096613
JET BLACK	096615

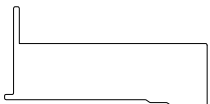

45° Corner Gasket
2 Required Per Unit
Apply One at each
corner at the head.

PART#		
WHITE	BLACK	SAND
096305	096306	096307

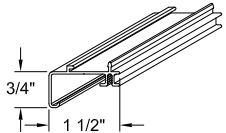

3/4" x 1 1/2" Simulated Aluminum Sill Nosing
Lineal Foot Part#s

COLOR	PART#
WHITE	012984
BRONZE	012985
SAND	012986
GREEN	012987
RED	012989
EGGSHELL	012990
JET BLACK	095633

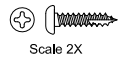

Pan Head Fastening screws
#6 x 5/8" for Head & Jamb's

Scale 2X

COLOR	PART#
WHITE	011635
BRONZE	011636
SAND	015517
GREEN	032142
RED	075321
EGGSHELL	075262

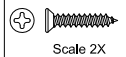

Flat Head ZINC screws
#6 x 3/4" PH FH for Sill

Scale 2X

PART#	COLOR
010608	ZINC
014799	WHITE
015583	SAND
032141	GREEN



HEAD DETAIL

HURD ENERGY SAVER CLAD CASEMENT OPERATING

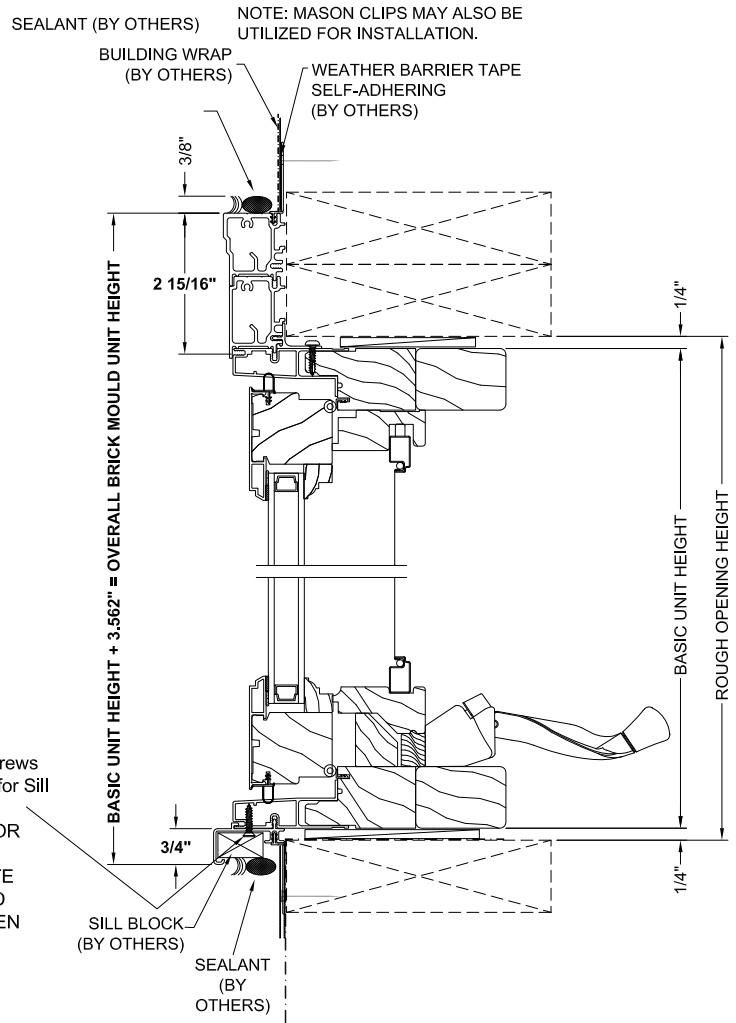

SILL DETAIL

HURD ENERGY SAVER CLAD CASEMENT OPERATING

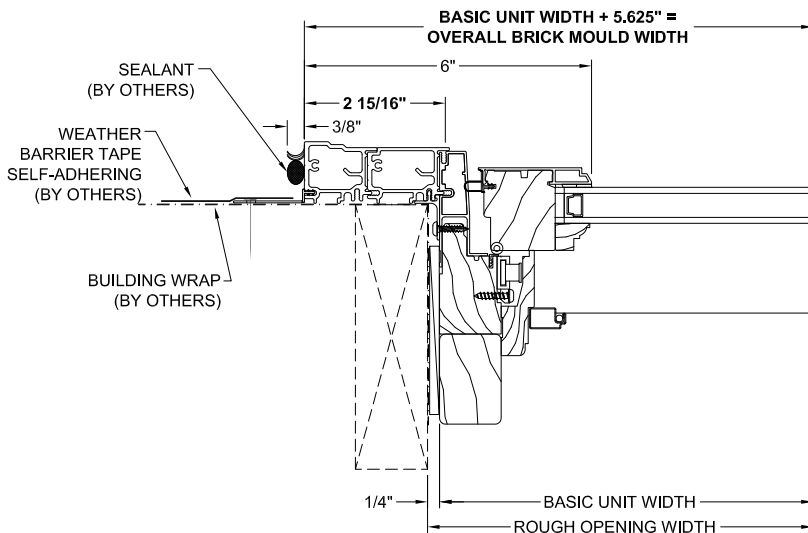

JAMB DETAIL

HURD ENERGY SAVER CLAD CASEMENT OPERATING (TYP.)

HWD Acquisition, Inc., offers these general suggestions for typical installations in the type of construction represented. This is a supplement and not a replacement to the full Installation Instructions provided by Hurd. You must use the full Installation Instructions in conjunction with this Installation suggestion supplement. Full Installation instruction can be found on the Hurd website, www.hurd.com. Installation requirements may vary in particular locations and in other types of construction. Proper installation is essential, and HWD Acquisitions, Inc., recommends consultation with an AAMA Certified Installer, or other qualified experienced building professional before installation of any Hurd product. Proper installation of Hurd products is the responsibility of the installer. Hurd is not responsible for proper installation, Hurd is not responsible for the design of, conditions in, or performance of building construction beyond the perimeters of the Hurd units. Hurd is not responsible for proper integration of the Hurd units with the weather-repellent systems of the building.



3 1/2" Aluminum Flat Casing for Aluminum/Wood Arch & Springline Products

2009

FORMULAS:

BRICK MOULD **HEIGHT** =
BASIC UNIT HEIGHT + 3.5625"

BRICK MOULD **WIDTH** =
BASIC UNIT WIDTH + 5.625"

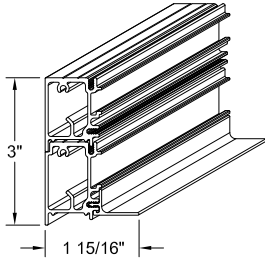

3 1/2" Aluminum Flat Casing L/F Part#s

COLOR	PART#
WHITE	096617
BRONZE	096618
SAND	096619
GREEN	096600
RED	096622
EGGSHELL	096621
JET BLACK	096623



45° Corner Gasket
2 Required Per Unit
Apply One at each
corner at the head.

PART#		
WHITE	BLACK	SAND
096302	096303	096304

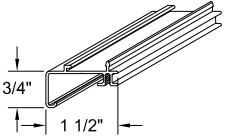

3/4" x 1 1/2" Simulated Aluminum Sill Nosing
Lineal Foot Part#s

COLOR	PART#
WHITE	012984
BRONZE	012985
SAND	012986
GREEN	012987
RED	012989
EGGSHELL	012990
JET BLACK	095633

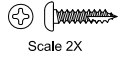

Pan Head Fastening screws
#6 x 5/8" for Head & Jamb

COLOR	PART#
WHITE	011635
BRONZE	011636
SAND	015517
GREEN	032142
RED	075321
EGGSHELL	075262



Flat Head ZINC screws
#6 x 3/4" PH FH for Sill

PART#	COLOR
010608	ZINC
014799	WHITE
015583	SAND
032141	GREEN

HEAD DETAIL
HURD ENERGY SAVER CLAD CASEMENT OPERATING

Scale: Drawn 1" = 1"

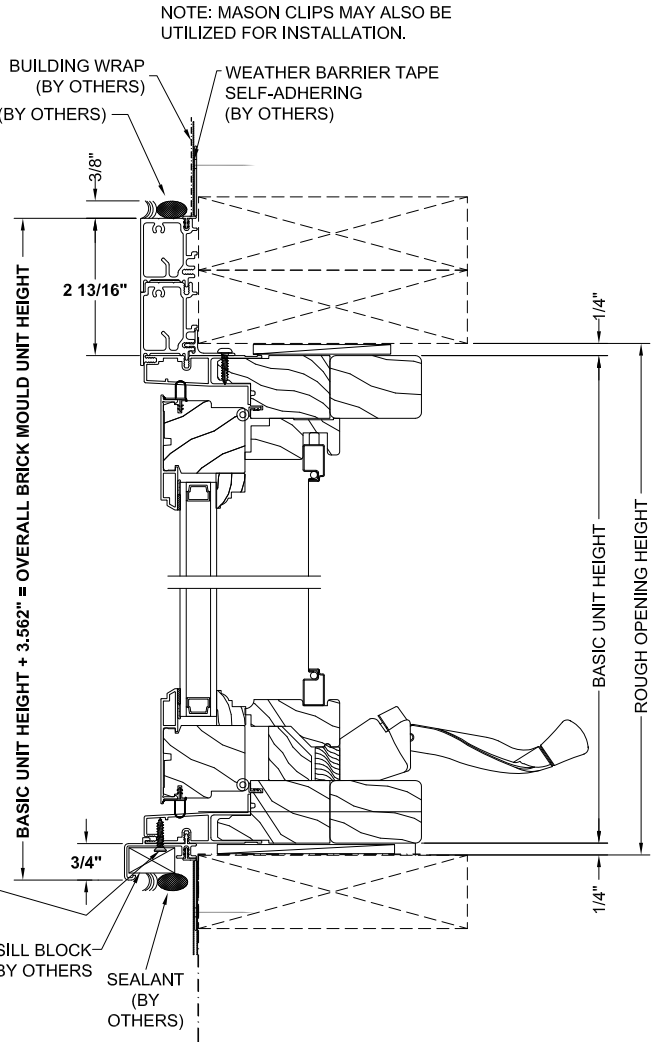

SILL DETAIL
HURD ENERGY SAVER CLAD CASEMENT OPERATING

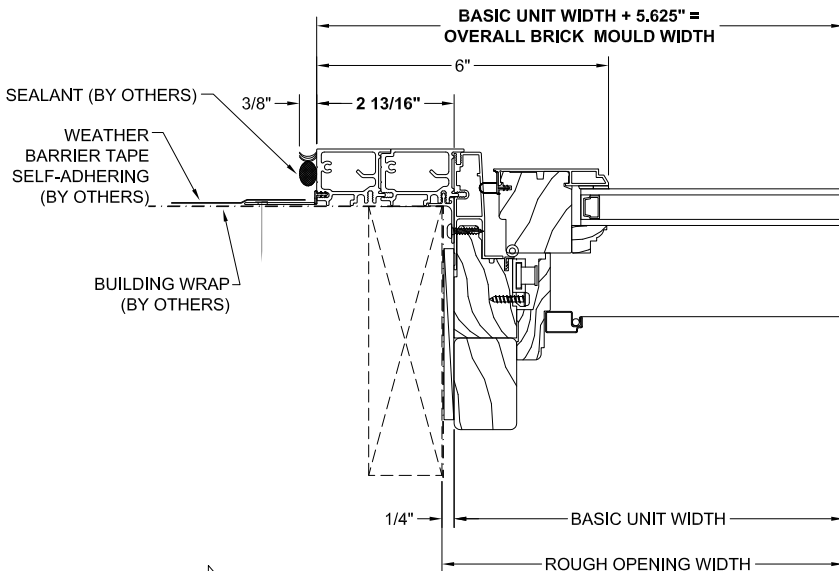

JAMB DETAIL
HURD ENERGY SAVER CLAD CASEMENT OPERATING (TYP.)

HWD Acquisitions, Inc., offers these general suggestions for typical installations in the type of construction represented. This is a supplement and not a replacement to the full installation instructions provided by Hurd. You must use the full installation instructions in conjunction with this installation suggestion supplement. Full Installation Instruction can be found on the Hurd website, www.hurd.com.

Installation requirements may vary in particular locations and in other types of construction. Proper installation is essential, and HWD Acquisitions, Inc., recommends consultation with an AAMA Certified Installer, or other qualified experienced building professional before installation of any Hurd product. Proper installation of Hurd products is the responsibility of the installer. Hurd is not responsible for proper installation, Hurd is not responsible for the design of, conditions in, or performance of building construction beyond the perimeters of the Hurd units. Hurd is not responsible for proper integration of the Hurd units with the weather-repellent systems of the building.