

- **Please note:** utilizing installation straps/clips is not a rated method of installation.

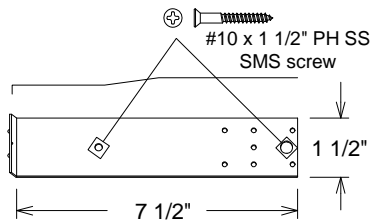
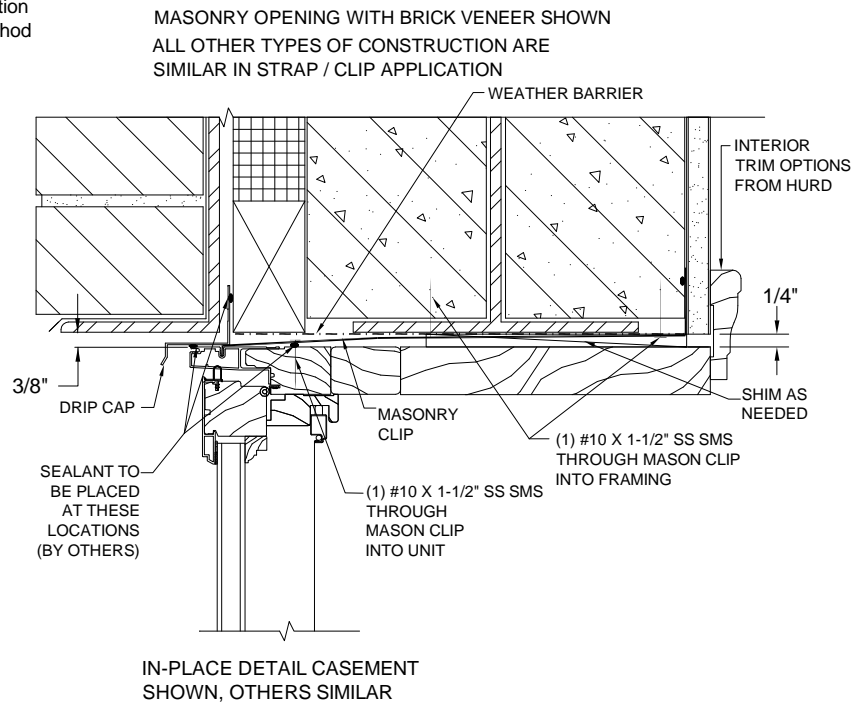

MASONRY ANCHOR CLIP - 7 1/2"

Usage: Replaces nailing fin for interior installation of windows or doors in most types of construction

Part No. 012230 (7 1/2"x 1 1/2" x 22GA)

Quantity & Attachment Method:

- Attach Clips to the unit before installing into the opening, using (1) #10 x 1-1/2" SS SMS screw for each clip.
- Place/fasten clips 6" from corners and space 12" on center around the perimeter of unit. Rotate clips so they are perpendicular to the unit.
- Continuous bead of sealant is to be placed around rough opening.
- Place unit into opening, make unit square, level and plumb. Fasten a shim block at each clip location, bend clip around and fasten to opening with (1) #10 x 1-1/2" SS SMS screw through clip.
- Mason Straps/Clips other than available thru Hurd will be provided by others.
- The installation methods utilized are at the discretion of the architect or installer to provide a weather tight installation for the application needed.
- Hurd Window & Doors is not responsible for completeness or quality of any installation.
- **Please note:** utilizing installation straps/clips is not a rated method of installation.

Hurd Windows & Doors offers these general suggestions for typical installations in the type of construction represented. This is a supplement and not a replacement to the full installation instructions provided by Hurd. You must use the full installation instructions in conjunction with this installation suggestion supplement. Full installation instruction can be found on the Hurd website, www.hurd.com

Installation requirements may vary in particular locations and in other types of construction. Proper installation is essential, and Hurd Windows & Doors recommends consultation with an AAMA Certified Installer, or other qualified experienced building professional before installation of any Hurd product. Proper installation of Hurd products is the responsibility of the installer. Hurd is not responsible for proper installation. Hurd is not responsible for the design of, conditions in, or performance of building construction beyond the perimeters of the Hurd units. Hurd is not responsible for proper integration of the Hurd units with the weather-repellent systems of the building.

- Typical location for installation straps for windows.
- Doors will have the same strap locations except they will not be placed at the sill.
- **Please Note:** This is a non-rated method of installation.

